

Grade 8 Lifting Points

Email: enquiries@cwssales.uk

XN173 Pivoting Lifting Eye Bolt

- Safety Factor 4:1

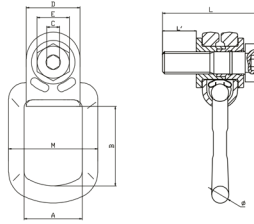

NOTE: We have Extra Long Thread Lengths in Stock.

Part Code	Size (mm)	Weight (kg)	WLL (T) 90°	A	B	C	D	E	M	L	L'	Ø
XN173-M08	M8	0.36	0.3	35	52.5	6	30	13	45	46	10.4	14
XN173-M10	M10	0.38	0.63	35	52.5	6	30	17	45	52	16	14
XN173-M12	M12	0.71	1	40	54	8	36	19	68	62	18	18
XN173-M14	M14	0.72	1.2	40	54	8	36	19	68	66	21	18
XN173-M16	M16	0.74	1.5	40	54	8	36	19	68	70	24	18
XN173-M18	M18	1.16	2	54	80	12	50	30	83	83	26	16
XN173-M20	M20	1.19	2.5	54	80	12	50	30	83	88	30	16
XN173-M24	M24	1.35	4	54	94	14	50	36	83	95	35	18
XN173-M27	M27	4.18	4	73	106	17	68	41	120	120	38	27
XN173-M30	M30	4.4	5	73	106	17	68	41	120	132	48	27
XN173-M36	M36	4.65	8	73	106	17	68	41	120	142	54	27
XN173-M42	M42	12.4	15	104	155	24	95	65	176	179	63	40
XN173-M48	M48	13	20	104	155	27	95	75	176	194	74	40

Size	1 Point (T) 0°	1 Point (T) 90°	2 Points (T) 0°	2 Points (T) 90°	2 Points (T) 0-45°	2 Points (T) 45-60°	3/4 Points (T) 0-45°	3/4 Points (T) 45-60°	3/4 Points Unsym (T)
M8	0.3	0.3	0.6	0.6	0.42	0.3	0.63	0.45	0.30
M10	0.63	0.63	1.26	1.26	0.88	0.63	1.32	0.95	0.63
M12	1	1	2	2	1.4	1	2.1	1.5	1
M14	1.2	1.2	2.4	2.4	1.68	1.2	2.52	1.8	1.2
M16	1.5	1.5	3	3	2.1	1.5	3.15	2.25	1.5
M18	2	2	4	4	2.8	2	4.2	3	2
M20	2.5	2.5	5	5	3.5	2.5	5.25	3.75	2.5
M24	4	4	8	8	5.6	4	8.4	6	4
M27	4	4	8	8	5.6	4	8.4	6	4
M30	5	5	10	10	7	5	10.5	7.5	5
M36	8	8	16	16	11.2	8	16.8	12	8
M42	15	15	30	30	21	15	31.5	22.5	15
M48	20	20	40	40	28	20	42	30	20

- Fatigue Rated x 1.5 WLL for 20,000 cycles
- 100% Magnaflux Crack Detected
- Proof Tested - 2.5 times Working Load Limit
- Super Alloy Steel